

9220/20

Gantrail Welded Base Fixing

www.gantrail.com



GANTRAIL®
A world of crane rail expertise

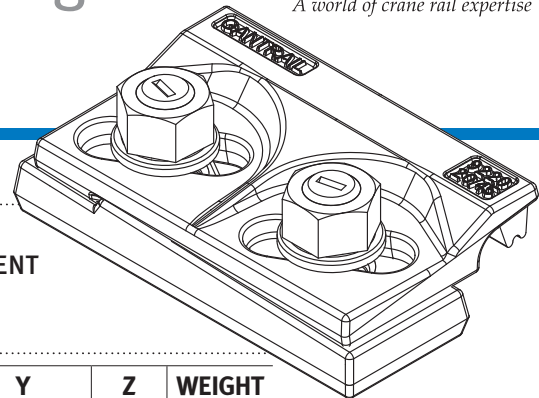

9220/20

The GANTRAIL 9220/20 adjustable crane rail clip is designed to fix the largest rails in the most arduous applications. It can withstand a horizontal force from the rail of 235kN (24 tonnes). Its low profile allows it to be used with cranes that are fitted with guide rollers.

SPECIFICATIONS:

MAX SIDE LOAD 235kN
20mm HORIZONTAL RAIL ADJUSTMENT

DIMENSIONS (mm):

| REF NO. | X | Y (FULL NUT) | Y (THIN NUT) | Z | WEIGHT kg |
|------------|----|--------------|--------------|----|-----------|
| 9220/20/40 | 40 | 57 | 49 | 33 | 2.48 |
| 9220/20/45 | 45 | 57 | 49 | 33 | 2.50 |
| 9220/20/52 | 52 | 57 | 49 | 33 | 2.62 |
| 9220/20/61 | 61 | 67 | N/A | 43 | 3.10 |

FEATURES

- The proven design has been used successfully for many years throughout the world.
- The clip is welded to the rail support. No access is required from below.
- The two main parts are locked together on tightening the grade 8.8 bolts.
- The clip has a self-tightening mechanism.
- A special vulcanised rubber block applies a controlled force to the rail.

COMPONENTS

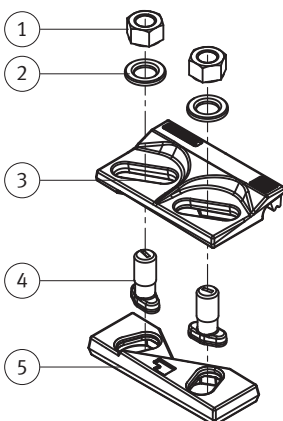

1. Nuts
2. Hardened washers
3. Clip cap with integral rubber block
4. M20 Captive bolts
5. Weldable base

1 RAIL WITH PAD

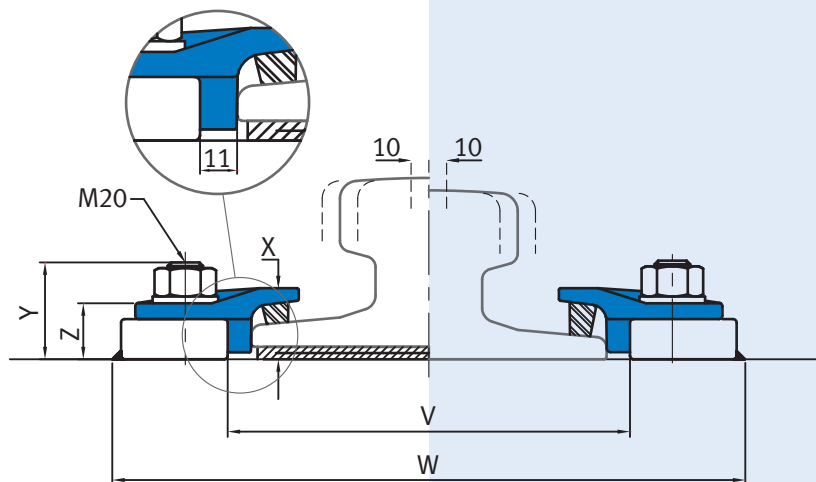

2 RAIL WITHOUT PAD

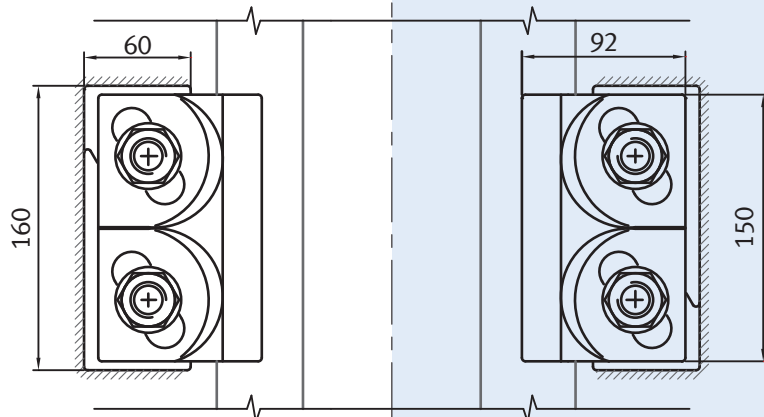

Minimum assembly width - $W = \text{Rail width (F)} + 160\text{mm}$ $V = \text{Rail width (F)} + 22\text{mm}$

9220/20

Gantrail Welded Base Fixing

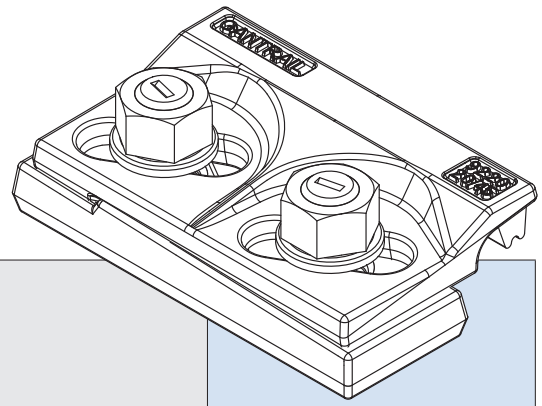

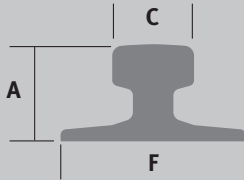
|  | F mm | C mm | A mm | 1. CLIP REFERENCE FOR RAIL WITH PAD | 2. CLIP REFERENCE FOR RAIL WITHOUT PAD |
|---|---------|---------|---------|--|---|
| A 100 | 200 | 100 | 95 | 9220/20/40 | 9220/20/40 |
| A 120 | 220 | 120 | 105 | 9220/20/40 | 9220/20/40 |
| A 150 | 220 | 150 | 150 | 9220/20/45 | 9220/20/40 |
| 89 kg CR | 178 | 102 | 114 | 9220/20/45 | 9220/20/40 |
| 164 kg CR | 230 | 140 | 150 | 9220/20/61 | 9220/20/52 |
| MRS 86 | 165 | 102 | 102 | 9220/20/40 | 9220/20/40 |
| MRS 87 A (PRI85R) | 152 | 102 | 152 | 9220/20/45 | 9220/20/40 |
| MRS 125 | 180 | 120 | 180 | 9220/20/52 | 9220/20/45 |
| MRS 192 | 229 | 140 | 157 | 9220/20/61 | 9220/20/52 |
| MRS 221 | 220 | 220 | 160 | 9220/20/45 | 9220/20/40 |
| ISCR 100 | 150 | 102 | 150 | 9220/20/40 | 9220/20/40 |
| ISCR 120 | 170 | 120 | 170 | 9220/20/45 | 9220/20/45 |
| ISCR 140 | 170 | 140 | 170 | 9220/20/45 | 9220/20/45 |
| QU 100 | 150 | 100 | 150 | 9220/20/40 | 9220/20/40 |
| QU 120 | 170 | 120 | 170 | 9220/20/45 | 9220/20/40 |
| ISCOR 57 | 140 | 70 | 165 | 9220/20/40 | 9220/20/40 |
| CR 73 | 140 | 100 | 135 | 9220/20/40 | 9220/20/40 |
| CR 100 | 155 | 120 | 150 | 9220/20/45 | 9220/20/40 |
| 73 kg AS | 146 | 70 | 157 | 9220/20/45 | 9220/20/40 |
| 86 kg AS | 165 | 102 | 102 | 9220/20/45 | 9220/20/40 |

THIS CLIP CAN BE USED FOR A WIDER SELECTION OF RAILS THAN ILLUSTRATED.

Please contact GANTRAIL for the full range of possible rails. All rails can be fastened with bolted or welded base clips. GANTRAIL may change or improve their products and also alter specifications without notice.

INSTALLATION INSTRUCTIONS:

Weld along back and sides of clip base with a 6mm throat thickness fillet weld. Weld in 'V' with a 4mm throat thickness fillet weld. Use low hydrogen electrodes.

If a continuous weld around the clip base is required, this is possible. Please consult GANTRAIL for guidance.

TIGHTENING TORQUE 250Nm

Please contact GANTRAIL, for full installation instructions.

WELD DETAIL

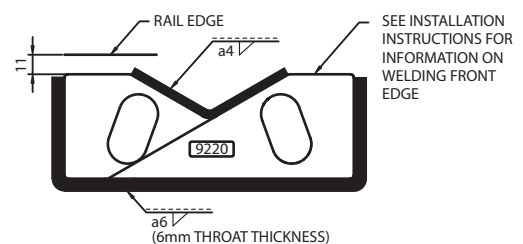

A world of crane rail expertise.

www.gantrail.com



Gantry Railing Ltd
Sudmeadow Road
Hempsted
Gloucester GL2 5HG
ENGLAND

Tel: +44 (0) 1452 300688
Fax: +44 (0) 1452 300198
E-mail: info@gantrail.com

Gantrail (Middle East) Ltd
P O Box 61428
Jebel Ali Free Zone
Dubai
United Arab Emirates

Tel: +971 4 8812 935
Fax: +971 4 8812 936
E-mail: gme@gantrail.com

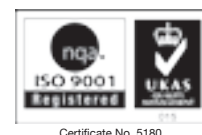

9220/20/ET/07/12