

THIRD ANGLE PROJECTION

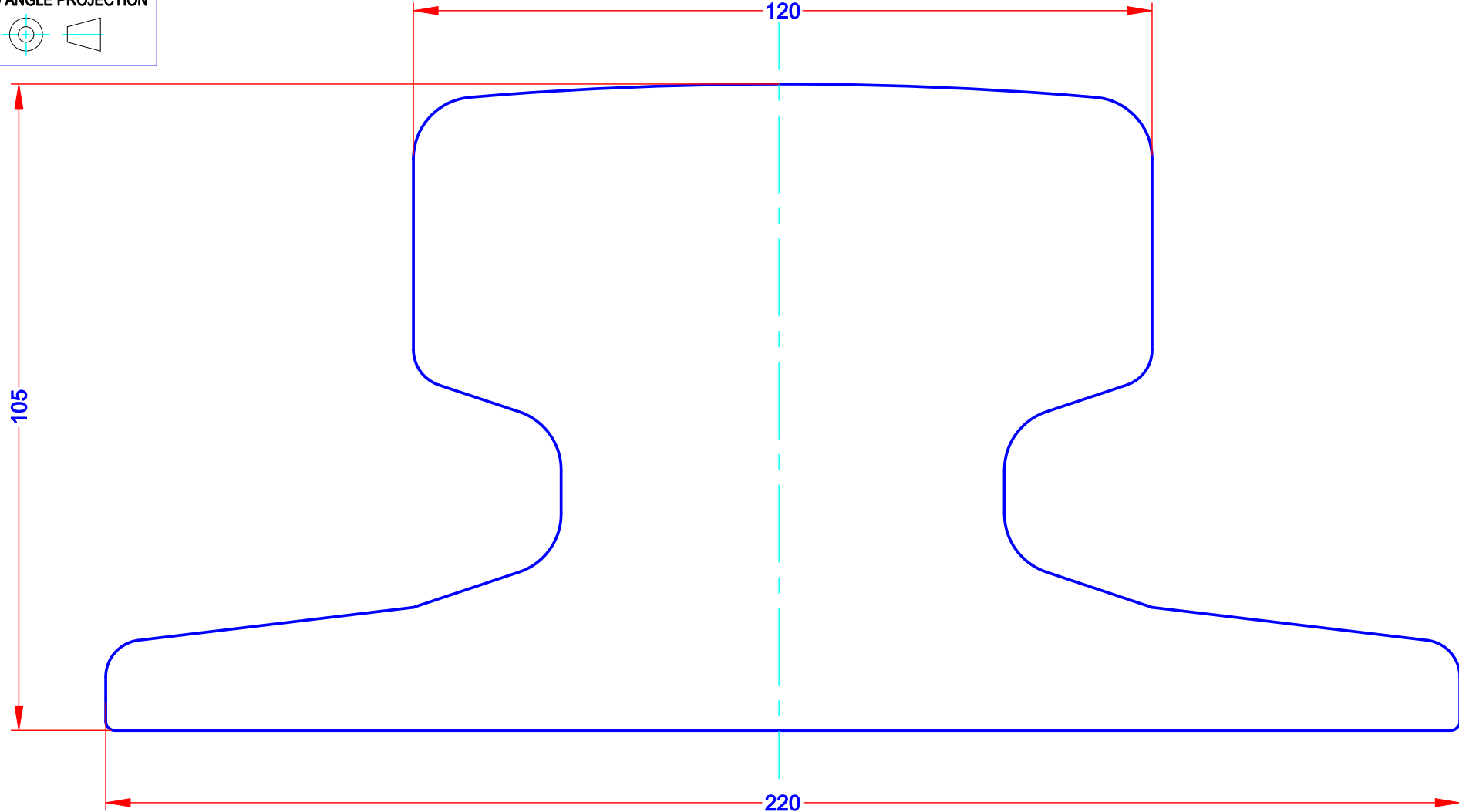
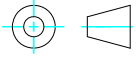

ASECOM[®]

Rail Mounting Systems

THE TECHNICAL DATA CONTAINED IN THIS DRAWING IS THE PROPERTY OF ASECOM RAILS COMPANY AND IS SUBJECT TO COPYRIGHT ©

ASECOM RAILS

20, Rue Maurice Barrés
57175 GANDRANGE
Tel: 0033.962.074.366
Fax: 0033.387.586.279
Gsm: 0033.673.587.415

e-mail: contact@asecomrails.com

Rail Designation	A120
Rail Origin	CEE
Standard	DIN 536
Area of section	12748 mm ²
Calculated Mass	100 kg/m
Neutral Axis to base	47.6 mm
Moment of Inertia	I _{xx} 1380 cm ⁴ I _{yy} 2336 cm ⁴

Edition	A
Date	29/10/02
Scale	1 :1 @ A4

FOR GUIDANCE ONLY
THIS INFORMATION HAS BEEN PROVIDED IN GOOD FAITH BUT SPECIFICATIONS DO CHANGE